



1K2K Dosing and Dispensing Private Limited

Plot No. A-44/1/A-55, Rajmata Jijau Mahila

Industrial Premises, Chakan MIDC Road,

Phase II, Vasuli, Tal-Khed, Dist. Pune- 410501



ADoST Manual Pinch Pen Manual

ABSTRACT

This document provides step by step handling and maintenance of ADoST Manual Pinch Pen, including but not limited to every aspect of the equipment that an operator is expected to know and observe.



1K2K Dosing and Dispensing Private Limited
Plot No. A-44/1/A-55, Rajmata Jijau Mahila
Industrial Premises, Chakan MIDC Road,
Phase II, Vasuli, Tal-Khed, Dist. Pune- 410501

ADoST- Manual Pinch Pen

Year of Manufacturing- 2025

USER MANUAL

Issue- April 2025

Revision- 1.0

Manufacturer - 1K2K Dosing and Dispensing Pvt. Ltd.

Address - Plot No. A-44/1/A-55, Rajmata Jijau Mahila Industrial Premises,
CHS, Chakan MIDC Road, Phase II, Vasuli, Tal-Khed, Dist. Pune- 410501



1K2K Dosing and Dispensing Private Limited
Plot No. A-44/1/A-55, Rajmata Jijau Mahila
Industrial Premises, Chakan MIDC Road,
Phase II, Vasuli, Tal-Khed, Dist. Pune- 410501

Revision history

| Document version | Date | Comments |
|------------------|------------|------------------|
| 1.0 | 20-04-2025 | Document created |



Information ownership

This Handbook is intended for the users of ADoST Manual Pinch Pen and for the education of maintenance technicians. Drawings, Instructions, Tables and anything else enclosed in this handbook are strictly technical and are the property of 1K2K Dosing and Dispensing and the same cannot be reproduced, divulged, either completely or partially, without written authorization by 1K2K Dosing and Dispensing Pvt. Ltd.

It is absolutely forbidden for the technicians and the operators to leak the information contained in this manual and to use this manual for a purpose different from those tied up to the good maintenance and use of the ADoST dosing system.

1K2K Dosing and Dispensing Pvt. Ltd. cannot be considered to be in charge or prosecutable for damages brought by wrong use of this user manual. It is important to read and to understand the whole documentation supplied with the system, in order to avoid hazards caused due to wrong operations or maintenance.



CONTENTS

| | | |
|-------|------------------------------|----|
| 1 | Definitions | 5 |
| 2 | Introduction..... | 6 |
| 3 | General Information..... | 7 |
| 4 | System's specifications..... | 8 |
| 4.1 | System Components..... | 8 |
| 4.2 | Detailed Dimensions..... | 9 |
| 4.2.1 | Front View | 9 |
| 4.2.2 | Side view | 9 |
| 5 | Safety precautions..... | 10 |
| 6 | System Setup | 11 |
| 6.1 | Part Identification | 11 |
| 6.2 | Tube insertion..... | 11 |
| 6.3 | Tube removal..... | 13 |
| 7 | System Do's and don'ts | 15 |



1K2K Dosing and Dispensing Private Limited
Plot No. A-44/1/A-55, Rajmata Jijau Mahila
Industrial Premises, Chakan MIDC Road,
Phase II, Vasuli, Tal-Khed, Dist. Pune- 410501

1 DEFINITIONS

| | | |
|----|----------|-----------------------------|
| 1. | User | The person using the system |
| 2. | Adhesive | Dispensing Adhesive |
| 3. | Tube | Pinch Tube |
| 4. | Al | Aluminium |



2 INTRODUCTION

The ADoST Manual Pinch Pen is an ergonomic and lightweight applicator designed for precise manual dispensing of continuous beads or microdots of low to medium viscosity liquids, including cyanoacrylates and anaerobic adhesives. Its ease of assembly and operation ensures minimal nozzle changeover time, enhancing user efficiency.

A key feature of this pen is its pinch tube, which is the only component in contact with the dispensed material. This design minimizes maintenance and reduces the risk of cross-contamination, as the tube can be easily replaced when necessary.

The ADoST Manual Pinch Pen is compatible with a variety of interchangeable fittings, allowing connection to pressurized reservoirs. This versatility makes it suitable for diverse applications, from industrial manufacturing to intricate laboratory tasks.

Incorporating the ADoST Manual Pinch Pen into your workflow can enhance precision and efficiency in dispensing tasks, making it a valuable tool for professionals handling adhesives and other viscous materials.



1K2K Dosing and Dispensing Private Limited
Plot No. A-44/1/A-55, Rajmata Jijau Mahila
Industrial Premises, Chakan MIDC Road,
Phase II, Vasuli, Tal-Khed, Dist. Pune- 410501

3 GENERAL INFORMATION

This Handbook is divided into sections to make it useful to understand every information about the system life cycle and to easily find that information necessary for the end user.

This document is specifically developed for ADoST Manual Pinch Pen model and the information given in this handbook can help users in achieving the best system performances while ensuring the long life-cycle to its components.

Due to ongoing developments and safety requirements and regulations system outfitting may be different from the one described in this document. In such a scenario, descriptions and procedures should be construed as generic. Quoted drawings and pictures are intended for example only.

4 SYSTEM'S SPECIFICATIONS

| 1 | Model Number | ADoST-MPP-3-0 | ADoST-MPP-6-0 |
|---|---------------------------|------------------------|---------------|
| 2 | Size (Metric) | 128mm X 45.91mm X 19mm | |
| 3 | Weight | 86gm | |
| 4 | Length | 128mm | |
| 5 | Diameter | 14mm | |
| 6 | Compactable Tube OD | 3mm | 6mm |
| 7 | Ambient temperature range | 10°C to +45°C | |
| 8 | Usage | Indoor use | |

4.1 SYSTEM COMPONENTS

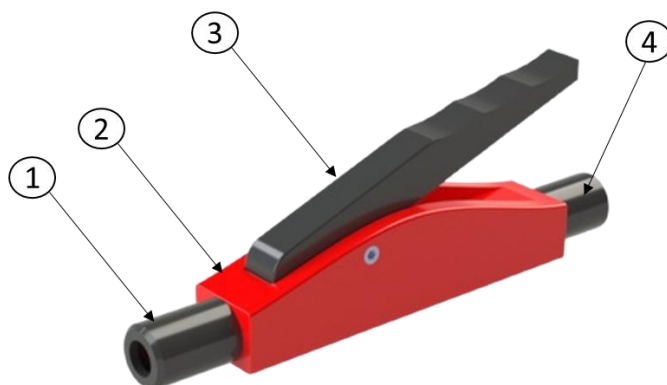

- Front Connector:** Provides external support for the tube, keeping the pinch tube securely in place during operation.
- Middle Body:** The ADoST Manual Pinch Pen has an aluminium body, making it lightweight and resistant to corrosion.
- Pinching Handle:** Used to pinch and control the flow through the tube.
- Back Connector:** Designed to hold the pinch tube in a fixed position.



1K2K Dosing and Dispensing Private Limited
Plot No. A-44/1/A-55, Rajmata Jijau Mahila
Industrial Premises, Chakan MIDC Road,
Phase II, Vasuli, Tal-Khed, Dist. Pune- 410501

4.2 DETAILED DIMENSIONS

All dimensions are in mm

4.2.1 Front View

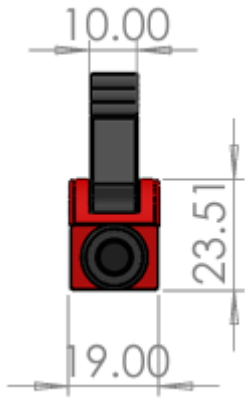



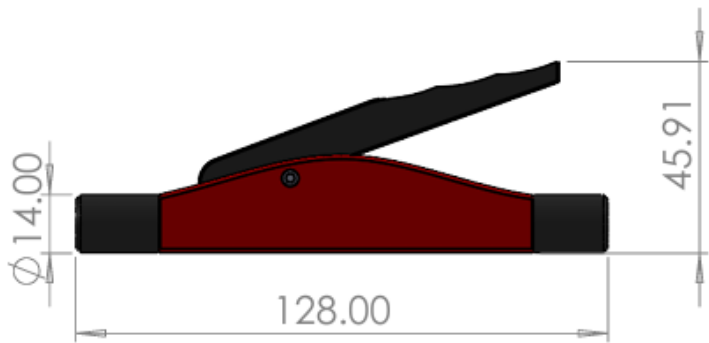

4.2.2 Side view





5 SAFETY PRECAUTIONS

| | | |
|----|---------------------|---|
| 1. | Wear safety gloves |  |
| 2. | Wear safety glasses |  |
| 3. | Wear face mask |  |
| 4. | Wear safety shoes |  |

6 SYSTEM SETUP

Below are the step-by-step instructions to be followed for setting up the system

6.1 PART IDENTIFICATION

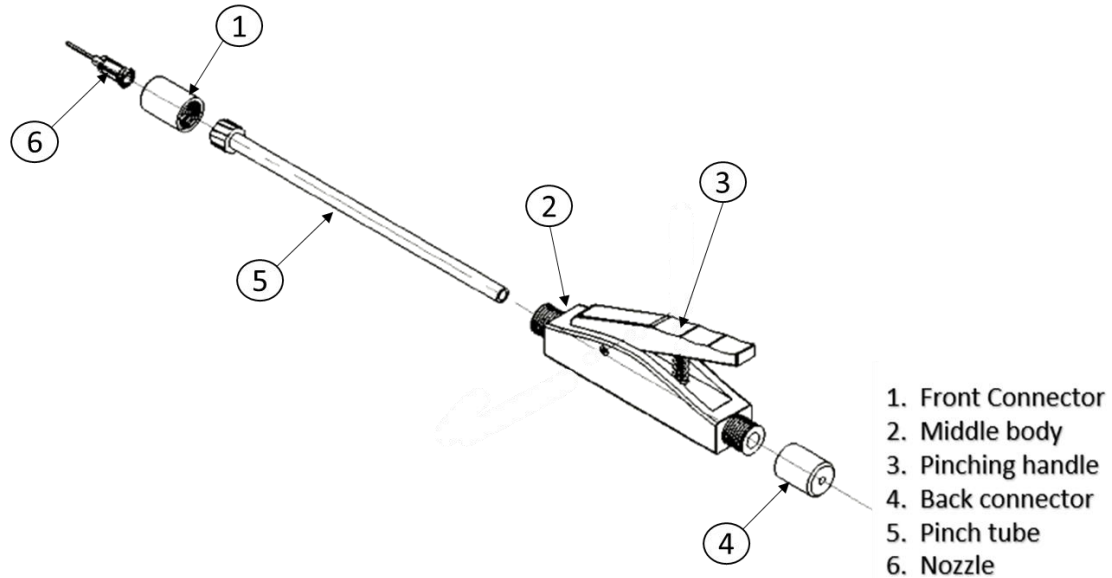

6.2 TUBE INSERTION

1. Detach Front connector (1) and Back connector (4) from Middle Body (2) by rotating which are connected through threading.
2. Press the Pinching handle (3) and pass Pinch Tube (5) through Middle Body (2) and make sure tube is completely inserted into Middle Body (2).

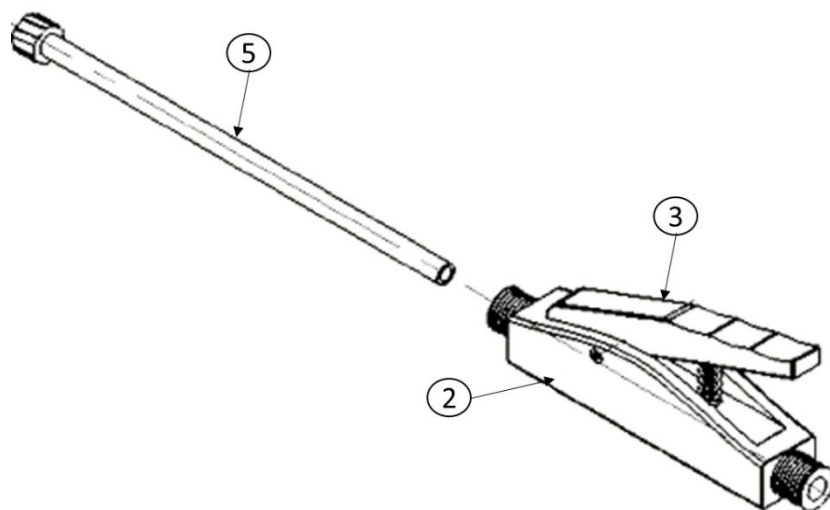

3. Connect Front connector (1) with Middle Body (2) by rotating clockwise.

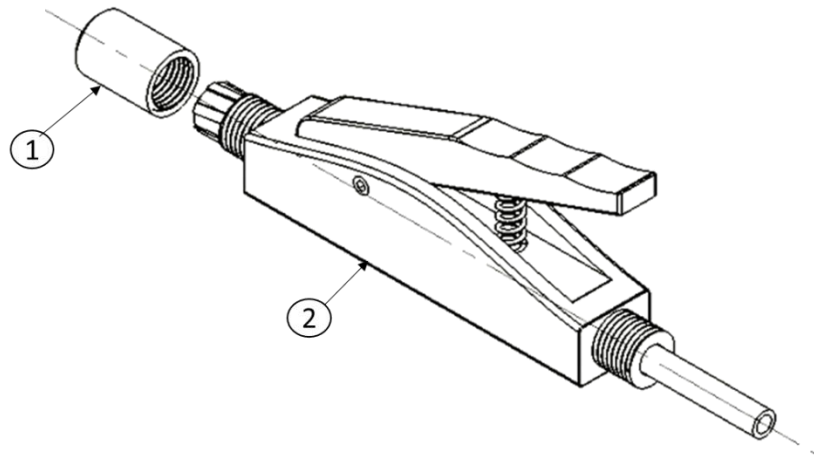

4. Insert Back connector (4) through another end of Pinch Tube (5) and tighten Back Part (4) with Middle Body (2) by clock wise rotation.

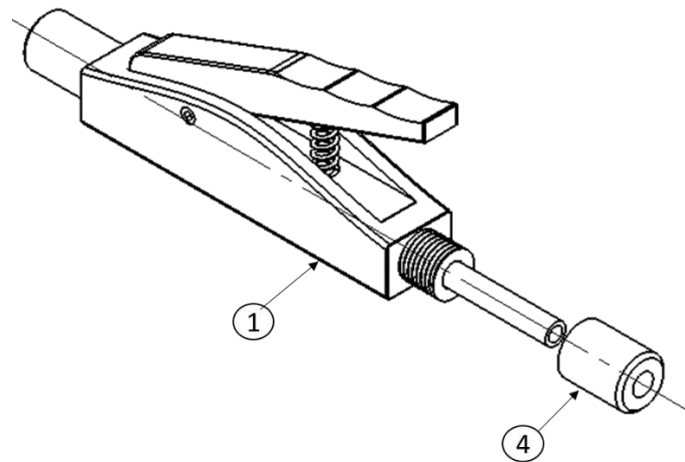

5. Connect Nozzle (6) with Front Connector (1) by rotating once.

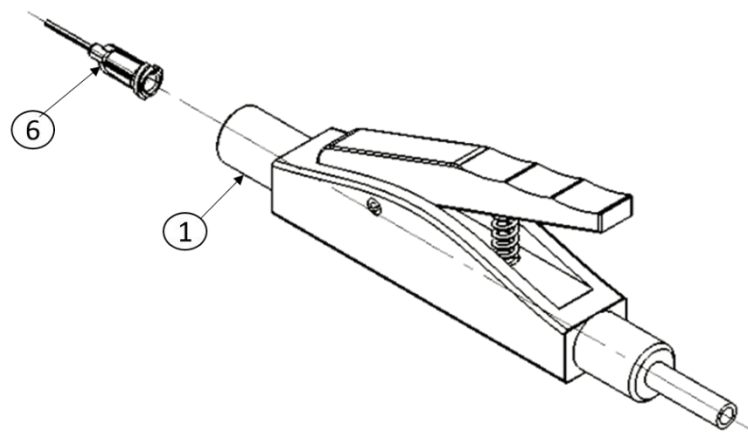

6.3 TUBE REMOVAL

1. Disconnect the air supply from the system or ensure the system is not in operation.
2. Hold Pen and Rotate Nozzle (6) counter clockwise to remove.

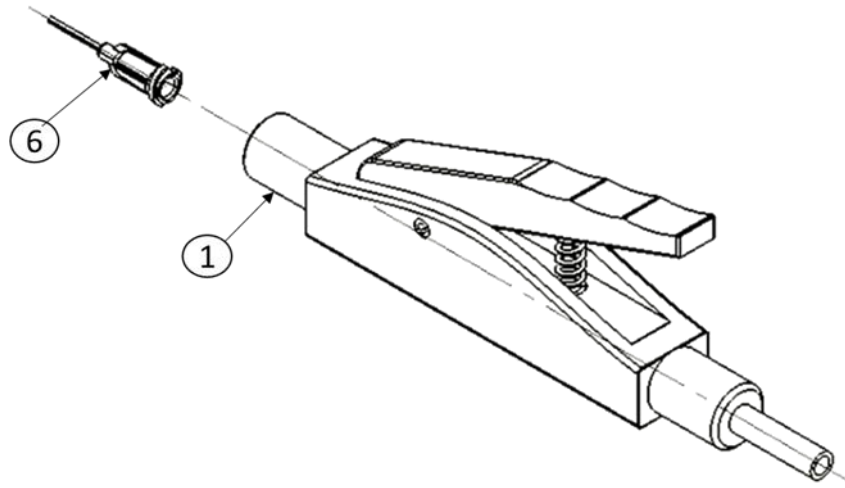

3. Make sure other end of pinch Tube is free from adhesive or any kind of attachment. Detach the Back Connector (4) by rotating counter clockwise.

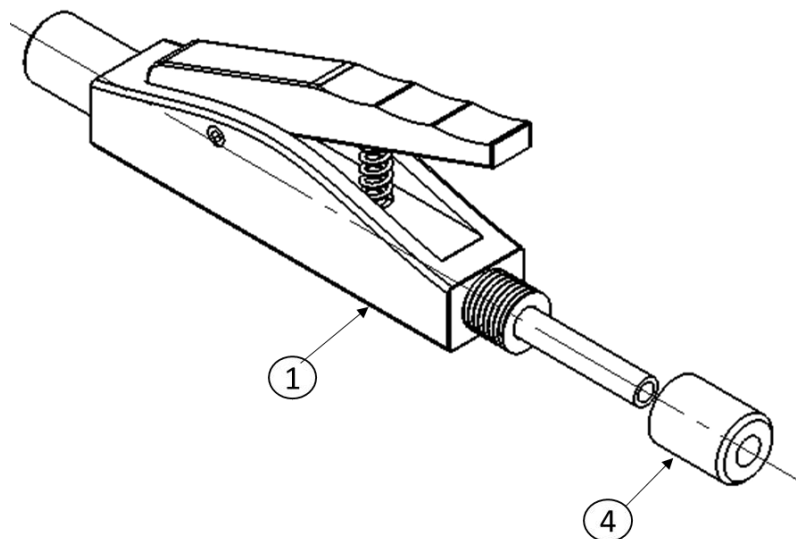

4. Further detach Front Connector (1) from assembly by rotating counter clockwise.

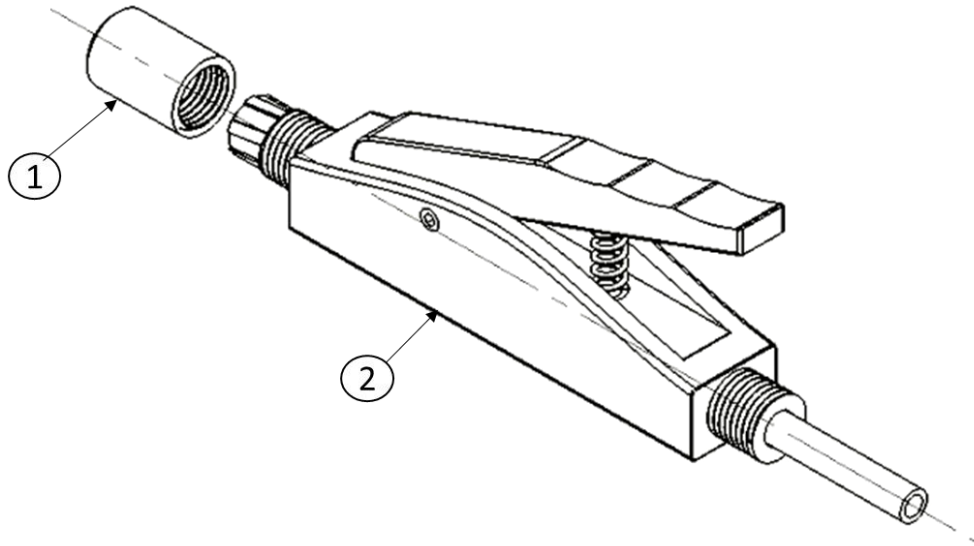

5. Press the Pinching handle (3) completely and pull Pinch Tube (5) from Middle Body (2) as shown in Figure.

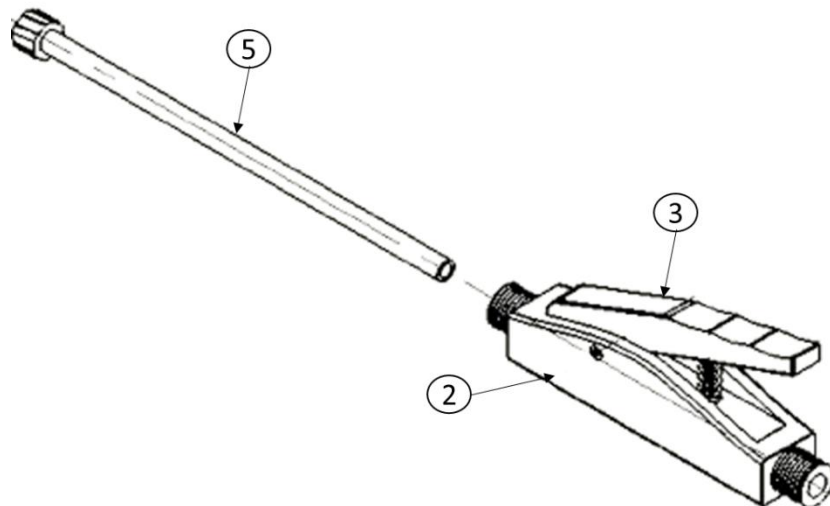



1K2K Dosing and Dispensing Private Limited
Plot No. A-44/1/A-55, Rajmata Jijau Mahila
Industrial Premises, Chakan MIDC Road,
Phase II, Vasuli, Tal-Khed, Dist. Pune- 410501

7 SYSTEM DO'S AND DON'TS

Do's

1. Depressurize the system to before changing the tube.
2. Ensure the tube surface is free from adhesive, while inserting or removing tube from ADoST Manual Pinch Pen.
3. If there is any leakage observed through connector, immediately depressurize the fluid.
4. While inserting and pulling the pinch tube press Pinching handle completely.

Don'ts

1. Don't disconnect the tube when the fluid inside tube is under pressure.
2. Don't remove the barb connector from ADoST Pinch Tube.
3. Do not Tighten thread too much to ensure threads are not damaged.
4. Don't pull the pinch tube force fully without following procedure to ensure Pen is not damaged.